

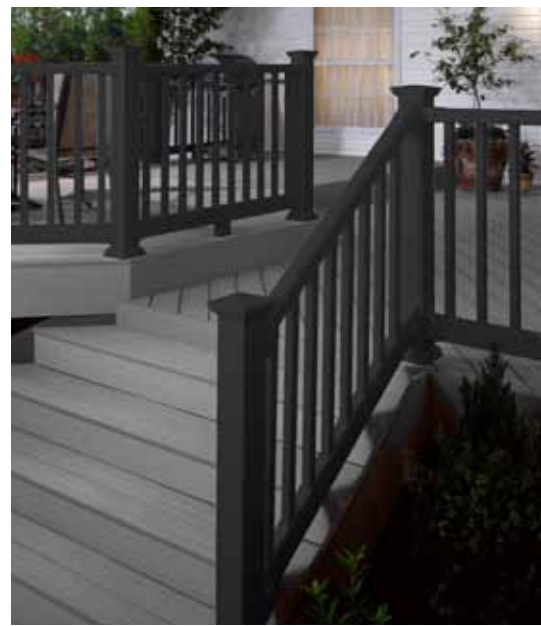

Low Maintenance Composite Railing



**SPECIAL
ORDER**
Pedido especial

Easy to buy, easy to build





MIX & MATCH

New for 2011! Severe Weather railing will now offer colored Deluxe and Flat rails and balusters. In addition to the white Deluxe rail systems, black and brown rails will now be available. Black and brown balusters will also be available to mix and match with the white, black or brown railing. Endless possibilities to custom design your rail.



White Deluxe Railing with Black Square Balusters



White Deluxe Railing with Brown Square Balusters



Black Flat Railing with Black Square Balusters



Brown Flat Railing with Brown Square Balusters



Black Deluxe Railing with Brown Square Balusters



Brown Deluxe Railing with Black Square Balusters



Black Deluxe Railing with White Square Balusters



Brown Deluxe Railing with White Square Balusters



Deluxe Railing



- Premium quality composite guard railing for porches and decks
- Decorative Top Rail
- Available in three colors to customize the outdoor living space
- Square Balusters or *Colonial Spindles
- Rails available in 6ft & 8ft lengths
- Stair rail kits available in 6ft lengths only
- Line and stair rail kits ship un-assembled in cartons and include hanging brackets.

*Colonial Spindles available in White only.

Colors Available:

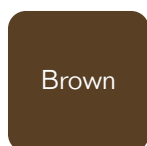
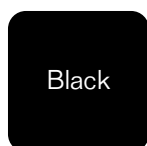

Note: Printed color swatches for reference only. Due to variations in offset and digital printing, actual product colors may vary. To ensure proper color matching, refer to physical product samples available at the Severe Weather Railing Display at Lowe's.

SOS Item Number	Sections & Accessories Description	Color	Vendor Model #	Lowe's Everyday Low Price
108128	6' DELUXE TOP STAIR RAIL/BOTTOM STAIR RAIL WHITE	White	RLB 2PK DEL STR 6 SW	
108128	6' DELUXE TOP RAIL/BOTTOM RAIL WHITE	White	RLB 2PK DELUXE 6 SW	
108128	8' DELUXE TOP RAIL/BOTTOM RAIL WHITE	White	RL 2PK DELUXE 8 SW	
108128	4" X 4" X 48" COMPOSITE STRUCTURAL POST WHITE	White	POST 4X4 48 SW	
108128	4" X 4" X 54" COMPOSITE STRUCTURAL POST WHITE	White	POST 4X4 54 SW	
108128	4" X 4" X 54" COMPOSITE POST SLEEVE WHITE	White	POST SLV COMP 48 SW	
108128	POST CAP GOTHIC WHITE	White	CAP GOTHIC 4 SW	
108128	POST CAP DOME WHITE	White	CAP DOME 4 SW	
108128	POST CAP BEVEL WHITE	White	CAP BEVEL 4 SW	
108128	POST CAP NEW ENGLAND WHITE	White	CAP N E 4 SW	
108128	POST BASE COVE MOULDING WHITE	White	POST SLV MLDG 4 SW	
108128	DELUXE STAIR/ANGLE BRACKETS – 2-PACK WHITE	White	BKT DS 2 PK SW	
108128	DELUXE LINE BRACKETS – 4-PACK WHITE	White	BKT D 4 PK SW	
108128	COLONIAL SPINDLE – 34" – 5-PACK WHITE	White	BAL COL 34 5PK TFSWM	
108128	SQUARE BALUSTER – 33.5" – 5-PACK WHITE	White	BAL SQ 33.5 5PK SW	
108128	SQUARE BALUSTER – 38" – 5-PACK WHITE	White	BAL SQ 38 5PK SW	
108128	6' DELUXE TOP STAIR RAIL/BOTTOM RAIL BLACK	Black	RLB 2PK DEL STR 6 BL	
108128	6' DELUXE TOP RAIL/BOTTOM RAIL BLACK	Black	RLB 2PK DELUXE 6 BL	
108128	8' DELUXE TOP RAIL/BOTTOM RAIL BLACK	Black	RL 2PK DELUXE 8 BL	
108128	4" X 4" X 48" COMPOSITE POST SLEEVE – BEADED BLACK	Black	POST SLV CMP 48B BLK	
108128	POST CAP HARBOUR BLACK	Black	CAP HARBOUR 4 BLACK	
108128	POST BASE COVE MOULDING BLACK	Black	POST SLV MLDG 4 BLK	
108128	DELUXE STAIR/ANGLE BRACKETS – 2-PACK BLACK	Black	BKT DS 2 PK BLACK SW	
108128	FLAT LINE BRACKETS – 4-PACK BLACK	Black	BKT F 4 PK BLACK SW	
108128	SQUARE BALUSTER – 33.5" – 5-PACK BLACK	Black	BAL SQ 33.5 5PK BL	
108128	SQUARE BALUSTER – 38" – 5-PACK BLACK	Black	BAL SQ 38 5PK BL	
108128	6' DELUXE TOP STAIR RAIL/BOTTOM STAIR RAIL BROWN	Brown	RLB 2PK DEL STR 6 BR	
108128	6' DELUXE TOP RAIL/BOTTOM RAIL BROWN	Brown	RLB 2PK DELUXE 6 BR	
108128	8' DELUXE TOP RAIL/BOTTOM RAIL BROWN	Brown	RL 2PK DELUXE 8 BR	
108128	4" X 4" X 48" COMPOSITE POST SLEEVE – BEADED BROWN	Brown	POST SLV CMP 48B BRN	
108128	POST CAP HARBOUR BROWN	Brown	CAP HARBOUR 4 BRN SW	
108128	POST BASE COVE MOULDING BROWN	Brown	POST SLV MLDG 4 BRN	
108128	DELUXE STAIR/ANGLE BRACKETS – 2-PACK BROWN	Brown	BKT DS 2 PK BROWN SW	
108128	DELUXE LINE BRACKETS – 4-PACK BROWN	Brown	BKT D 4 PK BROWN SW	
108128	SQUARE BALUSTER – 33.5" – 5-PACK BROWN	Brown	BAL SQ 33.5 5PK BR	
108128	SQUARE BALUSTER – 38" – 5-PACK BROWN	Brown	BAL SQ 38 RPK BR	
108128	POST BRACKET JOIST MOUNT	Brown	BKT POST JM 4 SW	
108128	POST BRACKET SURFACE MOUNT CONCRETE & WOOD	Brown	BKT POST MT CN/WD SW	
108128	POST SLEEVE SURFACE MOUNT KIT	Brown	BKT POST SLV MT SW	



Bevel Post Cap



New England Post Cap



Harbour Post Cap
Available in Black or Brown



Gothic Post Cap



Post Base Moulding

Product Information: www.severeweatherrail.com or 1-800-318-7828
Use SOS # 108128

CANCELLATION POLICY:

PLEASE CONTACT FIBER COMPOSITES, LLC FOR ORDER CANCELLATION. ORDERS CAN BE CANCELED UP TO 48 HOURS FROM SUBMISSION OF ORDER. FIBER COMPOSITES, LLC WILL MAKE EVERY EFFORT TO CANCEL AN ORDER IF THE ORDER HAS NOT SHIPPED OR BEEN STAGED FOR SHIPMENT.



Flat Railing



- Premium quality composite guard railing for porches and decks
- Flat Top Rail
- Available in three colors to customize the outdoor living space
- Square Balusters or *Colonial Spindles
- Rails available in 6ft & 8ft lengths
- Rail kits ship un-assembled in cartons and include hanging brackets.

*Colonial Spindles available in White only.

Colors Available:

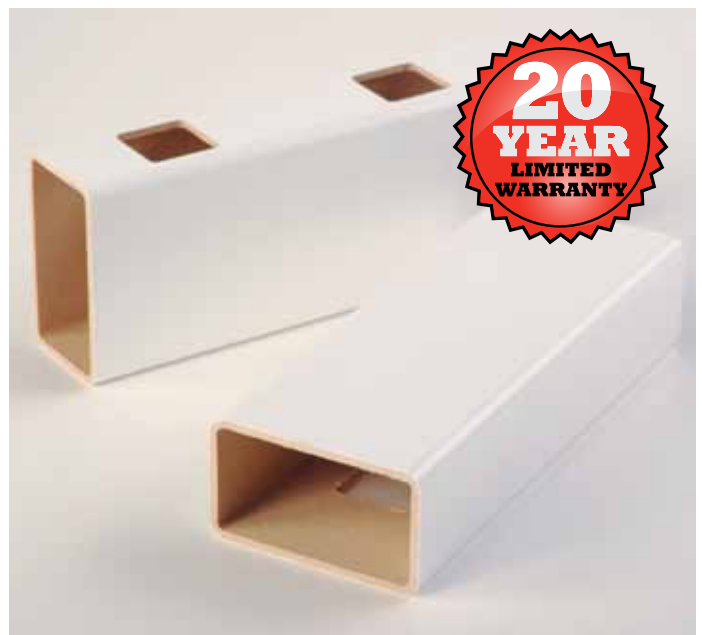
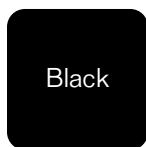

Note: Printed color swatches for reference only. Due to variations in offset and digital printing, actual product colors may vary. To ensure proper color matching, refer to physical product samples available at the Severe Weather Railing Display at Lowe's.

SOS Item Number	Sections & Accessories Description	Color	Vendor Model #	Lowe's Everyday Low Price
108128	6' DELUXE TOP STAIR RAIL/BOTTOM STAIR RAIL WHITE	White	RLB 2PK DEL STR 6 SW	
108128	6' FLAT TOP RAIL/BOTTOM RAIL WHITE	White	RLB 2PK FLAT 6 SW	
108128	8' FLAT TOP RAIL/BOTTOM RAIL WHITE	White	RL 2PK FLAT 8 SW	
108128	4" X 4" X 48" COMPOSITE STRUCTURAL POST WHITE	White	POST 4X4 48 SW	
108128	4" X 4" X 54" COMPOSITE STRUCTURAL POST WHITE	White	POST 4X4 54 SW	
108128	4" X 4" X 54" COMPOSITE POST SLEEVE WHITE	White	POST SLV COMP 48 SW	
108128	POST CAP GOTHIC WHITE	White	CAP GOTHIC 4 SW	
108128	POST CAP DOME WHITE	White	CAP DOME 4 SW	
108128	POST CAP BEVEL WHITE	White	CAP BEVEL 4 SW	
108128	POST CAP NEW ENGLAND WHITE	White	CAP N E 4 SW	
108128	POST BASE COVE MOULDING WHITE	White	POST SLV MLDG 4 SW	
108128	DELUXE STAIR BRACKETS - 2-PACK WHITE	White	BKT DS 2 PK SW	
108128	FLAT LINE BRACKETS - 4-PACK WHITE	White	BKT F 4 PK SW	
108128	FLAT ANGLE BRACKET - 2-PACK WHITE	White	BKT FAS 2 PK WHT SW	
108128	COLONIAL SPINDLE - 34" - 5-PACK WHITE	White	BAL COL 34 5PK TFSWM	
108128	SQUARE BALUSTER - 33.5" - 5-PACK WHITE	White	BAL SQ 33.5 5PK SW	
108128	SQUARE BALUSTER - 38" - 5-PACK WHITE	White	BAL SQ 38 5PK SW	
108128	6' DELUXE TOP STAIR RAIL/BOTTOM RAIL BLACK	Black	RLB 2PK DEL STR 6 BL	
108128	6' FLAT TOP RAIL/BOTTOM RAIL BLACK	Black	RLB 2PK FLAT 6 BL	
108128	8' FLAT TOP RAIL/BOTTOM RAIL BLACK	Black	RL 2PK FLAT 8 BL	
108128	4" X 4" X 48" COMPOSITE POST SLEEVE - BEADED BLACK	Black	POST SLV CMP 48B BLK	
108128	POST CAP HARBOUR BLACK	Black	CAP HARBOUR 4 BLACK	
108128	POST BASE COVE MOULDING BLACK	Black	POST SLV MLDG 4 BLK	
108128	DELUXE STAIR BRACKETS - 2-PACK BLACK	Black	BKT DS 2 PK BLACK SW	
108128	FLAT LINE BRACKETS - 4-PACK BLACK	Black	BKT F 4 PK BLACK SW	
108128	FLAT ANGLE BRACKET - 2-PACK BLACK	Black	BKT FAS 2 PK BLK SW	
108128	SQUARE BALUSTER - 33.5" - 5-PACK BLACK	Black	BAL SQ 33.5 5PK BL	
108128	SQUARE BALUSTER - 38" - 5-PACK BLACK	Black	BAL SQ 38 5PK BL	
108128	6' DELUXE TOP STAIR RAIL/BOTTOM STAIR RAIL BROWN	Brown	RLB 2PK DEL STR 6 BR	
108128	6' FLAT TOP RAIL/BOTTOM RAIL BROWN	Brown	RLB 2PK FLAT 6 BR	
108128	8' FLAT TOP RAIL/BOTTOM RAIL BROWN	Brown	RL 2PK FLAT 8 BR	
108128	4" X 4" X 48" COMPOSITE POST SLEEVE - BEADED BROWN	Brown	POST SLV CMP 48B BRN	
108128	POST CAP HARBOUR BROWN	Brown	CAP HARBOUR 4 BRN SW	
108128	POST BASE COVE MOULDING BROWN	Brown	POST SLV MLDG 4 BRN	
108128	DELUXE STAIR BRACKETS - 2-PACK BROWN	Brown	BKT DS 2 PK BROWN SW	
108128	FLAT LINE BRACKETS - 4-PACK BROWN	Brown	BKT F 4 PK BROWN SW	
108128	FLAT ANGLE BRACKET - 2-PACK BROWN	Brown	BKT FAS 2 PK BRN SW	
108128	SQUARE BALUSTER - 33.5" - 5-PACK BROWN	Brown	BAL SQ 33.5 5PK BR	
108128	SQUARE BALUSTER - 38" - 5-PACK BROWN	Brown	BAL SQ 38 RPK BR	
108128	POST BRACKET JOIST MOUNT	Brown	BKT POST JM 4 SW	
108128	POST BRACKET SURFACE MOUNT CONCRETE & WOOD	Brown	BKT POST MT CN/WD SW	
108128	POST SLEEVE SURFACE MOUNT KIT	Brown	BKT POST SLV MT SW	



Bevel Post Cap



New England Post Cap



Black Harbour Post Cap



Gothic Post Cap



Post Base Moulding

Product Information: www.severeweatherrail.com or 1-800-318-7828

Use SOS # 108128

CANCELLATION POLICY:

PLEASE CONTACT FIBER COMPOSITES, LLC FOR ORDER CANCELLATION. ORDERS CAN BE CANCELED UP TO 48 HOURS FROM SUBMISSION OF ORDER. FIBER COMPOSITES, LLC WILL MAKE EVERY EFFORT TO CANCEL AN ORDER IF THE ORDER HAS NOT SHIPPED OR BEEN STAGED FOR SHIPMENT.



ClearVisionSystem™



- Elegantly stylish top rails in Deluxe and Flat profiles
- Available in White Rails only
- Available in Clear or Bronze panels
- Available in 6 ft sections
- Permanent finish—low maintenance at a competitive price

PANELS SOLD SEPARATELY
PANELS 1/4" THICK

Colors Available:



Note: Printed color swatches for reference only. Due to variations in offset and digital printing, actual product colors may vary. To ensure proper color matching, refer to physical product samples available at the Severe Weather Railing Display at Lowe's.

SOS Item Number	Sections & Accessories Description	Color	Vendor Model #	Lowe's Everyday Low Price
108128	ACRYLIC PANEL CLEARVISIONSYSTEM 28.5 X 65" CLEAR	Clear	ACRYLIC SHEET CLEAR	
108128	ACRYLIC PANEL CLEARVISIONSYSTEM 28.5 X 65" BRONZ	Bronze	ACRYLIC SHEET BRONZ	
108128	6' DELUXE CLEARVISIONSYSTEM KIT WHITE	White	SECB CVS D 6 KD W/HW	
108128	6' FLAT CLEARVISIONSYSTEM KIT WHITE	White	SECB CVS F 6 KD W/HW	
108128	6' TOP RAIL DELUXE UNROUTED WHITE	White	RLB D U6	
108128	6' TOP/BOTTOM RAIL FLAT UNROUTED WHITE	White	RLB F U6	
108128	4" X 4" X 48" COMPOSITE STRUCTURAL POST WHITE	White	POST 4X4 48 SW	
108128	4" X 4" X 54" COMPOSITE STRUCTURAL POST WHITE	White	POST 4X4 54 SW	
108128	4" X 4" X 48" COMPOSITE POST SLEEVE WHITE	White	POST SLV COMP 48 SW	
108128	POST CAP GOTHIC WHITE	White	CAP GOTHIC 4 SW	
108128	POST CAP DOME WHITE	White	CAP DOME 4 SW	
108128	POST CAP BEVEL WHITE	White	CAP BEVEL 4 SW	
108128	POST CAP NEW ENGLAND WHITE	White	CAP N E 4 SW	
108128	POST BASE COVE MOULDING WHITE	White	POST SLV MLDG 4 SW	
108128	DELUXE STAIR BRACKETS – 2-PACK WHITE	White	BKT DS 2 PK SW	
108128	DELUXE LINE BRACKETS – 4-PACK WHITE	White	BKT D 4 PK SW	
108128	FLAT LINE BRACKETS – 4-PACK WHITE	White	BKT F 4 PK SW	
108128	FLAT ANGLE BRAKET – 2-PACK WHITE	White	BKT FAS 2 PK WHT SW	
108128	POST BRACKET JOIST MOUNT	N/A	BKT POST JM 4 SW	
108128	POST BRACKET SURFACE MOUNT CONCRETE & WOOD	N/A	BKT POST MT CN/WD SW	
108128	POST SLEEVE SURFACE MOUNT KIT	N/A	BKT POST SLV MT SW	

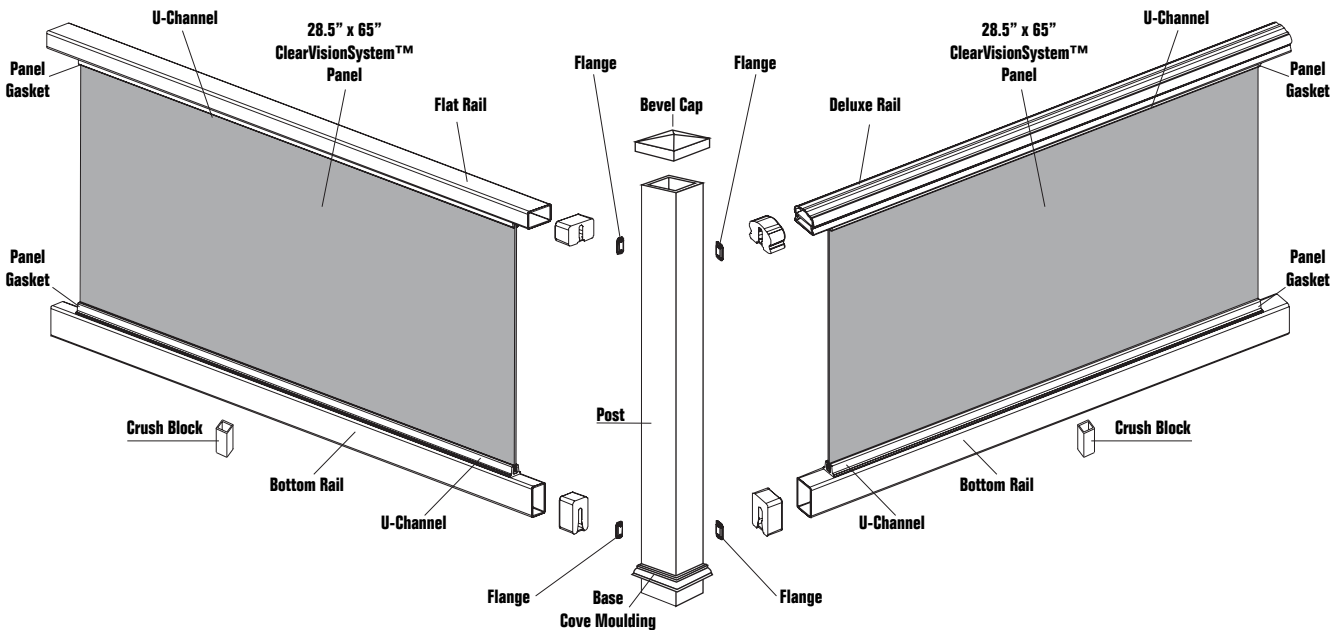

Product Information: www.severeweatherrail.com or 1-800-318-7828
 Use SOS # 108128

CANCELLATION POLICY:

PLEASE CONTACT FIBER COMPOSITES, LLC FOR ORDER CANCELLATION. ORDERS CAN BE CANCELED UP TO 48 HOURS FROM SUBMISSION OF ORDER. FIBER COMPOSITES, LLC WILL MAKE EVERY EFFORT TO CANCEL AN ORDER IF THE ORDER HAS NOT SHIPPED OR BEEN STAGED FOR SHIPMENT.



ADA Handrail



- ADA code compliant hand rail
- Works with Deluxe, Flat and Value Rail profiles
- Available in three colors, White, Black and Brown
- Permanent finish—low maintenance at a competitive price

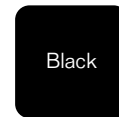

Note: Printed color swatches for reference only. Due to variations in offset and digital printing, actual product colors may vary. To ensure proper color matching, refer to physical product samples available at the Severe Weather Railing Display at Lowe's.



Rail with Stiffener - 104"



End Loop



Adjustable Joiner



Straight Joiner



Post Return



90 Degree Inside Corner Bracket Kit



90 Degree Corner



Rail End Cap



Hand Rail Bracket Kit



Joint Ring



Bracket Wall Return Cover



Straight Wall Return



Wall Return Kit

SOS Item Number	Sections & Accessories Description	Color	Vendor Model #	Lowe's Everyday Low Price
108128	ADA RAIL W/STIFFENER-104" WH	White	ADA RL STIFF 104 W	
108128	ADA WALL RETURN KIT WH	White	ADA WALL RET KIT W	
108128	ADA STRAIGHT WALL RET KIT WH	White	ADA ST WALL RET KT W	
108128	ADA HAND RAIL BRACKET KIT WH	White	ADA HAND RL BKT KT W	
108128	ADA 90 DEGREE CORNER WH	White	ADA 90 DEG CORNER W	
108128	ADA END LOOP WH	White	ADA END LOOP W	
108128	ADA POST RETURN WH	White	ADA POST RETURN W	
108128	ADA STRAIGHT JOINER WH	White	ADA STR JOINER W	
108128	ADA ADJUSTABLE JOINER WH	White	ADA ADJ JOINER W	
108128	ADA JOINT RING WH	White	ADA JOINT RING W	
108128	ADA RAIL END CAP WH	White	ADA RL END CAP W	
108128	ADA BKT WALL RET CVR PLATE WH	White	ADA BKT WAL RT CP W	
108128	ADA 90 DEG INS CRNR BKT KIT WH	White	ADA 90D I-C-BKT KT W	

SOS Item Number	Sections & Accessories Description	Color	Vendor Model #	Lowe's Everyday Low Price
108128	ADA RAIL W/STIFFENER-104" BLACK	Black	ADA RL STIFF 104 BL	
108128	ADA WALL RETURN KIT BLACK	Black	ADA WALL RET KIT BL	
108128	ADA STRAIGHT WALL RET KIT BLACK	Black	ADA ST WALL RET KT BL	
108128	ADA HAND RAIL BRACKET KIT BLACK	Black	ADA HAND RL BKT KT BL	
108128	ADA 90 DEGREE CORNER BLACK	Black	ADA 90 DEG CORNER BL	
108128	ADA END LOOP BLACK	Black	ADA END LOOP BL	
108128	ADA POST RETURN BLACK	Black	ADA POST RETURN BL	
108128	ADA STRAIGHT JOINER BLACK	Black	ADA STR JOINER BL	
108128	ADA ADJUSTABLE JOINER BLACK	Black	ADA ADJ JOINER BL	
108128	ADA JOINT RING BLACK	Black	ADA JOINT RING BL	
108128	ADA RAIL END CAP BLACK	Black	ADA RL END CAP BL	
108128	ADA BKT WALL RET CVR PLATE BLACK	Black	ADA BKT WAL RT CP BL	
108128	ADA 90 DEG INS CRNR BKT KIT BLACK	Black	ADA 90D I-C-BKT KT BL	

SOS Item Number	Sections & Accessories Description	Color	Vendor Model #	Lowe's Everyday Low Price
108128	ADA RAIL W/STIFFENER-104" BROWN	Brown	ADA RL STIFF 104 BR	
108128	ADA WALL RETURN KIT BROWN	Brown	ADA WALL RET KIT BR	
108128	ADA STRAIGHT WALL RET KIT BROWN	Brown	ADA ST WALL RET KT BR	
108128	ADA HAND RAIL BRACKET KIT BROWN	Brown	ADA HAND RL BKT KT BR	
108128	ADA 90 DEGREE CORNER BROWN	Brown	ADA 90 DEG CORNER BR	
108128	ADA END LOOP BROWN	Brown	ADA END LOOP BR	
108128	ADA POST RETURN BROWN	Brown	ADA POST RETURN BR	
108128	ADA STRAIGHT JOINER BROWN	Brown	ADA STR JOINER BR	
108128	ADA ADJUSTABLE JOINER BROWN	Brown	ADA ADJ JOINER BR	
108128	ADA JOINT RING BROWN	Brown	ADA JOINT RING BR	
108128	ADA RAIL END CAP BROWN	Brown	ADA RL END CAP BR	
108128	ADA BKT WALL RET CVR PLATE BROWN	Brown	ADA BKT WAL RT CP BR	
108128	ADA 90 DEG INS CRNR BKT KIT BROWN	Brown	ADA 90D I-C-BKT KT BR	

Product Information: www.severeweatherrail.com or 1-800-318-7828

Use SOS # 108128

CANCELLATION POLICY:

PLEASE CONTACT FIBER COMPOSITES, LLC FOR ORDER CANCELLATION. ORDERS CAN BE CANCELED UP TO 48 HOURS FROM SUBMISSION OF ORDER. FIBER COMPOSITES, LLC WILL MAKE EVERY EFFORT TO CANCEL AN ORDER IF THE ORDER HAS NOT SHIPPED OR BEEN STAGED FOR SHIPMENT.

Rail Installation INSTRUCTIONS



Low Maintenance Composite Railing



Deluxe Top Rail Profile



Flat Top Rail Profile

Required Tools and Supplies:

- For Structural Posts Only:
 - Post Brackets
 - Carriage Bolt, Washer & Nuts
 - Socket Wrench & Socket
- Drill & Driver Bit
- Protective Eye Wear
- Tape Measure
- Level
- Drill
- Screw Driver
- Speed Square
- Miter Saw
- Pencil

Railing component list for each section:

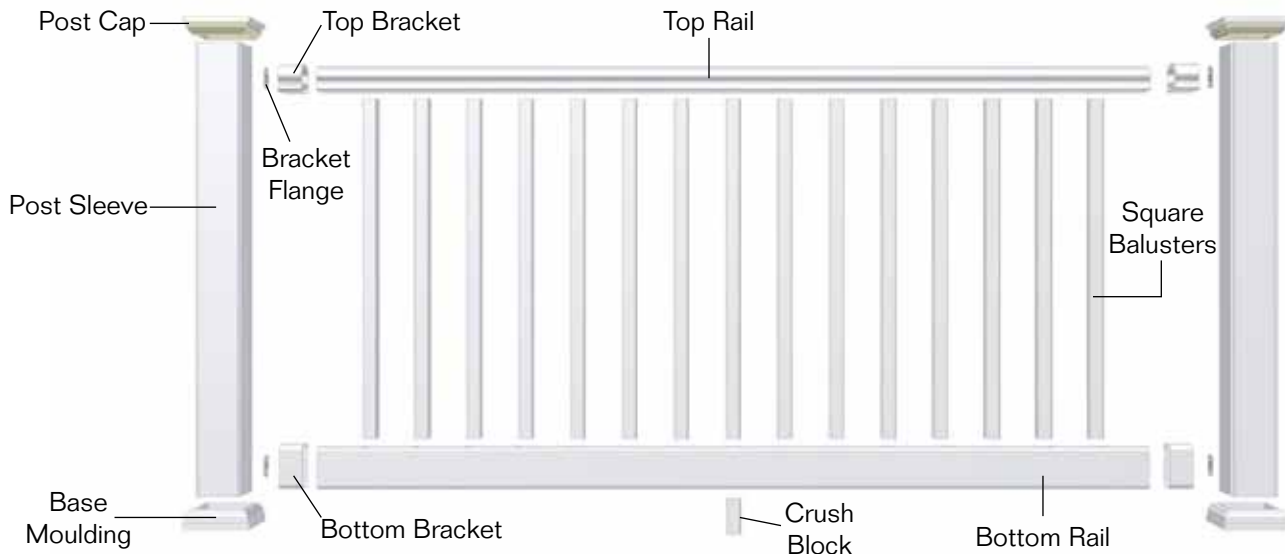

Prior to installing railing:

Please consult local zoning laws in regards to load requirements and bottom space requirements for rails. All supporting structures must be in accordance with applicable building codes. Neighborhood associations and/or historic districts may regulate size, type, placement and ability of railing. Apply for permits if required by local authorities and codes. Ensure compliance prior to installation. Local building code requirements will always supersede any and all suggested procedures and measurements in the following installation. The following installation instructions are intended as a general guideline based on common building practices used in railing installation.

Rail Installation:

Trim both ends of rail equally to maintain uniform baluster spacing. Ensuring trim mark does not create an open baluster mount hole at the bracket is critical; adjust accordingly noting uniform baluster spacing.



When railing span is greater than the distance between posts, trim both top and bottom rail ends equally. Measure distance, subtract 1/2" from measurement (1/4" on each side) to allow for brackets and flanging. Slide Cove Molding over each post prior to installing bottom rails and press securely into place.

Line Rail Installation:

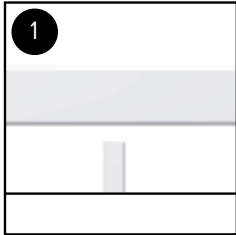

1 Center crush block on deck surface. Set bottom rail on top of crush block.

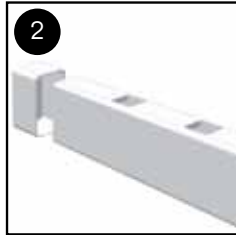

2 Place rail bracket onto end of bottom rail.

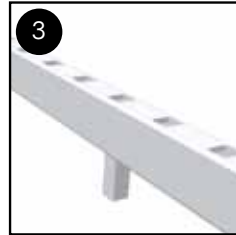

3 Place rail between posts.

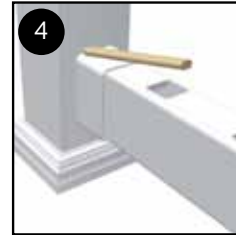

4 Trace around line rail bracket.



5 Remove rail and mark bracket flange holes.



6 Pre-drill holes: .125" or 1/8" bit. Attach bracket flange.

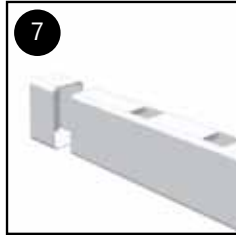

7 Place rail bracket onto end of bottom rail.

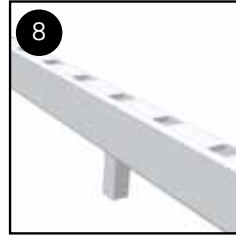

8 Place rail between posts.



9 Snap/lock rail in place. Glue crush block to bottom rail.

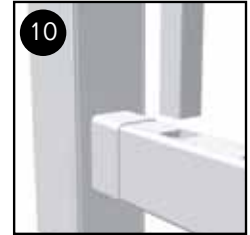

10 Insert balusters, one baluster at each end.



11 Place rail bracket over rail.

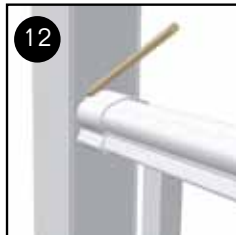

12 Place top rail. Trace around rail bracket.

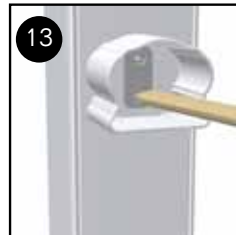

13 Remove rail and mark bracket flange.



14 Pre-drill holes: .125" or 1/8" bit. Attach bracket flange.



15 Insert all balusters in bottom rail.



16 Place rail bracket over top rail.



17 Seat balusters in to top rail. Snap/lock rail in place.

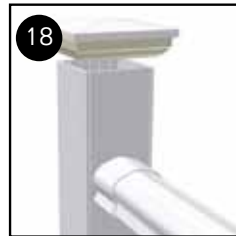

18 Glue post cap onto post sleeve.

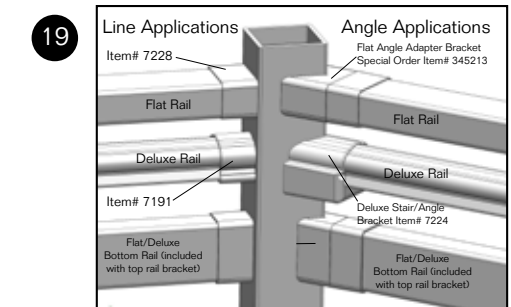

Stair Rail Installation:

TIP: Place a straight item such as a 4' level on stairs to determine consistent spacing

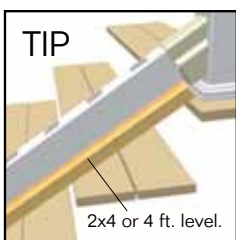

TIP: Place a straight item such as a 4' level on stairs to determine consistent spacing

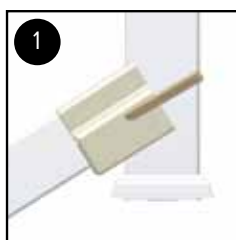

1 Mark and Trim at angles through stair/angle brackets, balusters and rails concurrently at a 32 degree slope on a traditional 7 inch rise and 11 inch run.

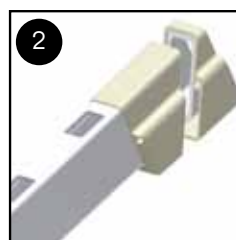

2 Place bottom rail against post: mark, pre-drill and screw.

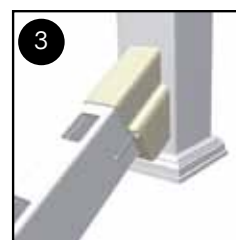

3 Insert balusters.

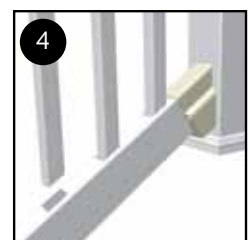

4 Completed Stair Rail Section.

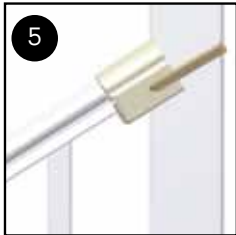

5 Mark and Trim at angles through brackets and rails concurrently.

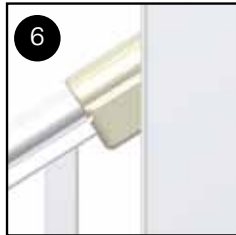

6 Seat baluster in to top rail. Place top rail against post: mark, pre-drill and screw.

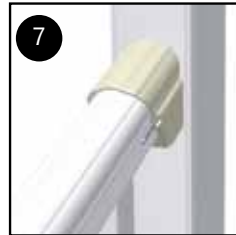

7 Glue post cap onto post sleeve.

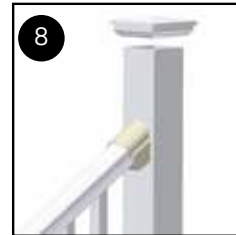

8 Completed Stair Rail Section.

CVS Installation INSTRUCTIONS



Low Maintenance Composite Railing

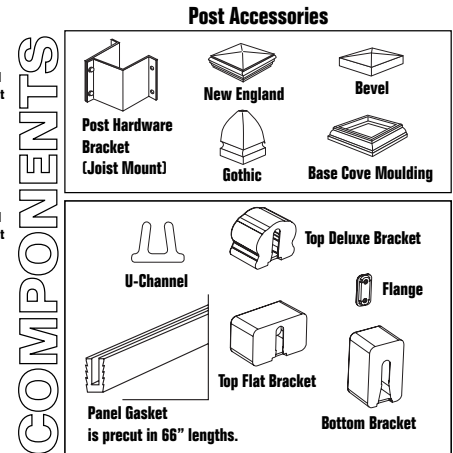
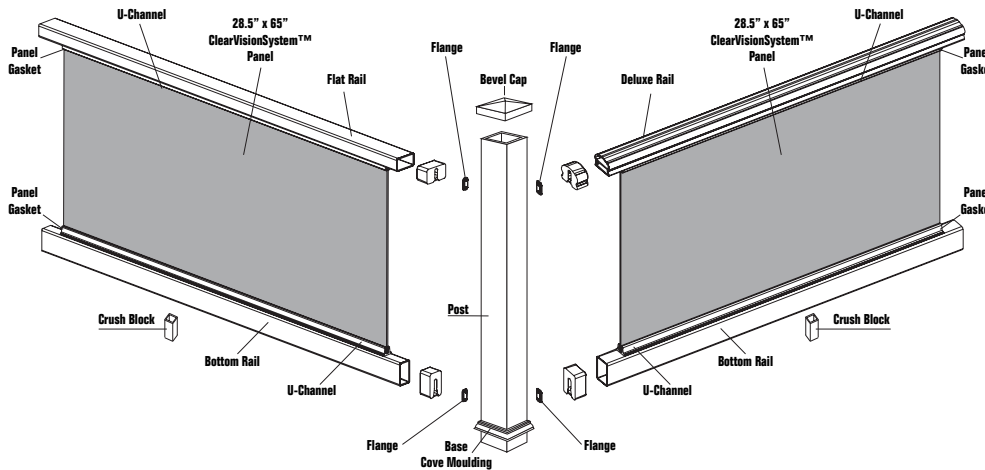

Kit Includes: 1-Top rail, 1-bottom rail, 2-top rail brackets, 2-bottom rail brackets, 4 flanges, 2-U-channels, 2-panel gaskets, and 1 crush block. All other pieces sold separately.

PRIOR TO INSTALLATION, CONSULT LOCAL BUILDING CODE REQUIREMENTS
For more detailed instructions visit us online at www.severeweatherrail.com

1. Measure the inside distance between the posts.
2. Cut rails 1/2" less than the distance between the posts.
3. Cut **ClearVisionSystem™** panel, U-Channels and panel gaskets 7" shorter than the length of the rails. Instructions for cutting **ClearVisionSystem™** panel are located at the end of this instruction sheet.
4. Center U-Channel on top surface of bottom rail (fig. A). The U-Channel should be 3.5" away from the end of the rail (fig. B).
5. Mark a hole location inside the U-Channel and along the center of the U-Channel. The hole should be 1" away from the end of the U-Channel (fig. C). Repeat for opposite end of U-Channel.
6. Measure the distance between the two holes on the U-Channel and divide the distance by 6 to determine the remaining screw spacing. Mark desired screw locations on inside of U-Channel. Predrill 1/8" hole at desired locations through the U-channel and the top wall thickness of the bottom rail. (correct drill depth shown in fig. D). **DO NOT DRILL THROUGH THE ENTIRE RAIL.**
7. Secure U-channel to the bottom rail with seven #10 x 1" flat head screws. **DO NOT OVERTIGHTEN.**
8. Repeat steps 4-7 for the top rail. The U-Channel will be attached to the underside of the top rail (fig. B). **DO NOT DRILL THROUGH THE ENTIRE RAIL.**
9. Partially peel back the **ClearVisionSystem™** panel's masking from the top and bottom edge (approx. 2" from the edge).
10. Place panel gasket on top and bottom edges of panel. Gasket should cover entire length of the panel.
11. Mix a warm soapy water solution (mix 3-5 drops of liquid detergent in one quart of warm water).
12. Lubricate all exterior surfaces of bottom panel gasket and inside of bottom rail's U-channel by wetting with the soapy solution.

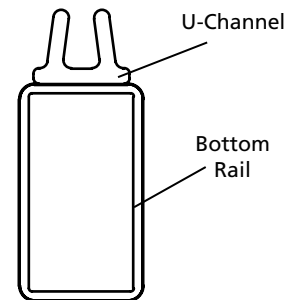

Figure A

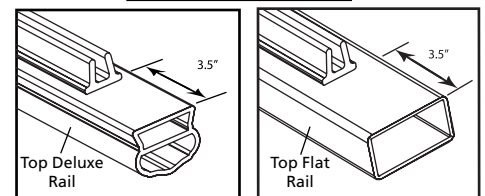
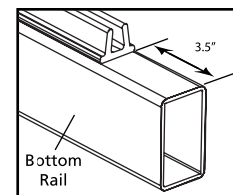

Figure B

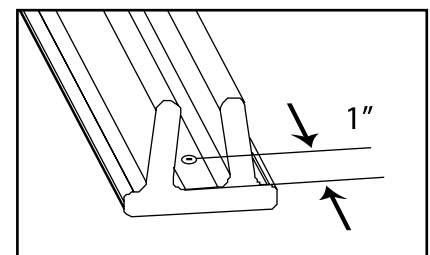

Figure C

***Severe Weather** Composite Railing can be cut easily with any cross cut handsaw or circular saw using a 32 tooth carbide blade.

13. Place **ClearVisionSystem™** panel and gaskets onto the opening of the bottom U-Channel (fig. E). The end of the panel should be flush with the end of the U-Channel. Starting at one end, force the panel downward into the opening of the U-Channel until the gasket and panel are fully engaged in the U-Channel (full engagement is achieved when only one rib of the panel gasket is visible from the U-Channel). If necessary, start at one end using a wood 2x4 (as a buffer) and a hammer to force the panel and gasket into the U-Channel (fig. E). Work toward the opposite end of the top panel gasket.
14. Lubricate all exterior surfaces of the top panel gasket and inside of the top rail's U-Channel by wetting with soapy solution.
15. Position the top rail above the panel gasket with the U-Channel opening on top of the panel gasket. Ensure that the end of the U-Channel is flush with the end of the panel. Starting at one end, push downward on the top rail while moving down the length of the rail. Ensure that the panel and gasket are fully engaged into the U-Channel. (Full engagement is achieved when only one rib of the panel gasket is visible from the U-Channel). If necessary, start at one end using a wood 2x4 (as a buffer) and a hammer to engage the panel and gasket into the top rail U-Channel.
16. Ensure that the base cove moulding is in place at the bottom of each post.
17. Place the crush block on the deck surface midway between the posts.
18. Position a bottom rail bracket over each end of the bottom rail. Position a top rail bracket over each end of the top rail.
19. Place the section with brackets on the crush block and between the posts. Ensure that the section is level and the brackets are centered on the posts.
20. Mark the top and bottom rail bracket locations on the post (fig. F). Repeat for the opposite end.
21. Remove the section from between the posts. Remove a top and bottom rail bracket from each rail.
22. Reposition the bottom rail bracket at the desired location on the post. Position the flange inside the bracket. Mark the two flange hole locations on the post (fig. G). Pre-drill a 1/8" hole at the desired locations. Repeat for opposite end.
23. Secure the bottom flange to the post with two #10 x 1" long screws (fig. H). Repeat for the opposite end. **DO NOT OVERTIGHTEN.**
24. Repeat steps 22-23 for the top rail flanges.
25. Reposition the top and bottom rail brackets over the rail ends. Reposition the section between the posts and above the flanges. Gently push down on the top rail until all four rail flanges are secured inside the rail bracket (fig. I).
26. Remove masking from both sides of the **ClearVisionSystem™** panel.
27. Using PVC cement, glue crush block to underside of bottom rail midway between the posts.
28. Mount and glue post caps on posts after all rail sections are installed.

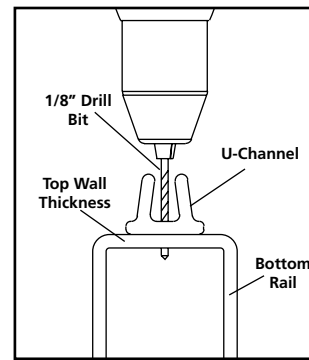

Figure D

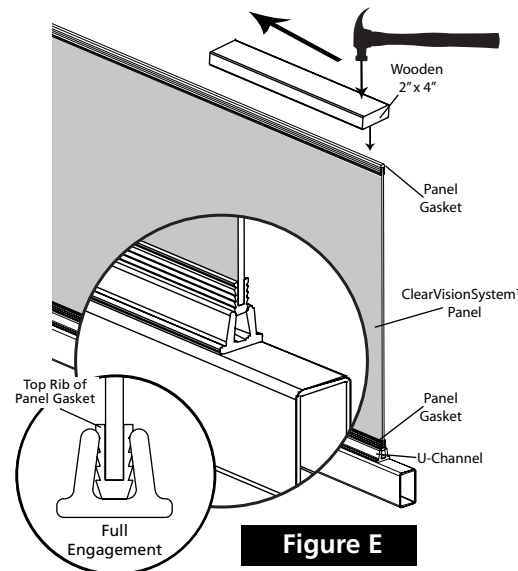

Figure E

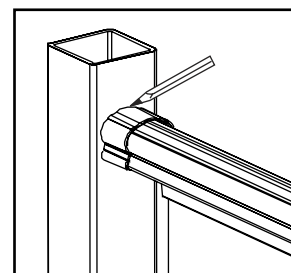

Figure F

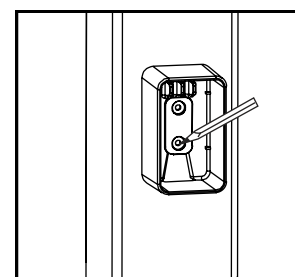

Figure G

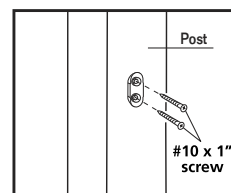

Figure H

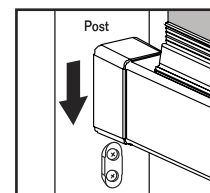

Figure I

CUTTING ACRYLIC PANELS

Leave polyethylene masking in place while cutting to size (Polyethylene masking acts as a lubricant). Sharp saw blade teeth are essential for achieving good results. Carbide tipped saw blades are recommended for superior cuts. A 10-inch diameter, 80-tooth blade is recommended for all-purpose cutting. (For more detailed cutting information, see www.cyro.com).

1. Using 1" masking tape, mask off area to be cut.
2. For best results, set cutting depth at 1/16" and make 4 passes, increasing depth 1/16" each time.
3. Remove sharp edges from panel before assembly in rail section.



Low Maintenance Composite Railing



**SPECIAL
ORDER**
Pedido especial

Easy to build, easy to buy

